

# Franke Fuji U Spout Tap

## Replacing Cartridge and O-Rings

### Replacing the cartridge

Before replacing the cartridge, you will need to turn the water off. You will need to remove the handle retaining screw (1) by using a 2mm allen key. Once this is removed, you'll be able to pull the handle (2) from the tap. You can then unscrew the cartridge cover (3) by unscrewing it anticlockwise. You'll then need to unscrew the cartridge locking ring (4) by using an adjustable spanner. You can then remove the cartridge (5) and fit the replacements.

### Replacing the o rings

To replace the o rings, you will need to remove the spout retaining screw (6) by using a 2.5mm allen key. Once the spout (7) is removed, you can replace the o rings (8) with the replacement parts.

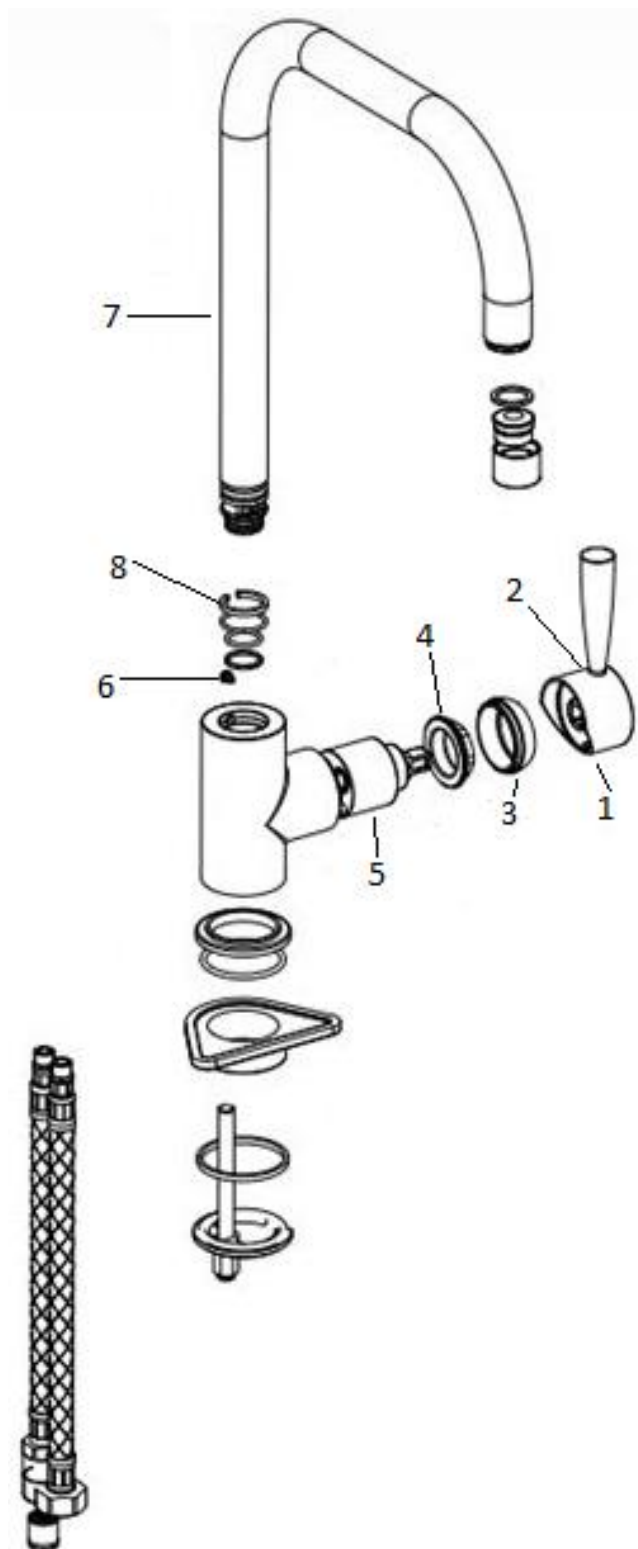

Central Services Ltd  
Unit 17 Park Hall Business Village  
Park Hall Road  
Stoke-on-Trent  
ST3 5XA

01782 599258  
[ks-ukcentralservices.gb@franke.com](mailto:ks-ukcentralservices.gb@franke.com)

*Make  
it  
Wonderful*

**FRANKE**